

MODIFIED PERMANENT SHEET PILING WALL WELDING DETAILS
SCALE: NTS

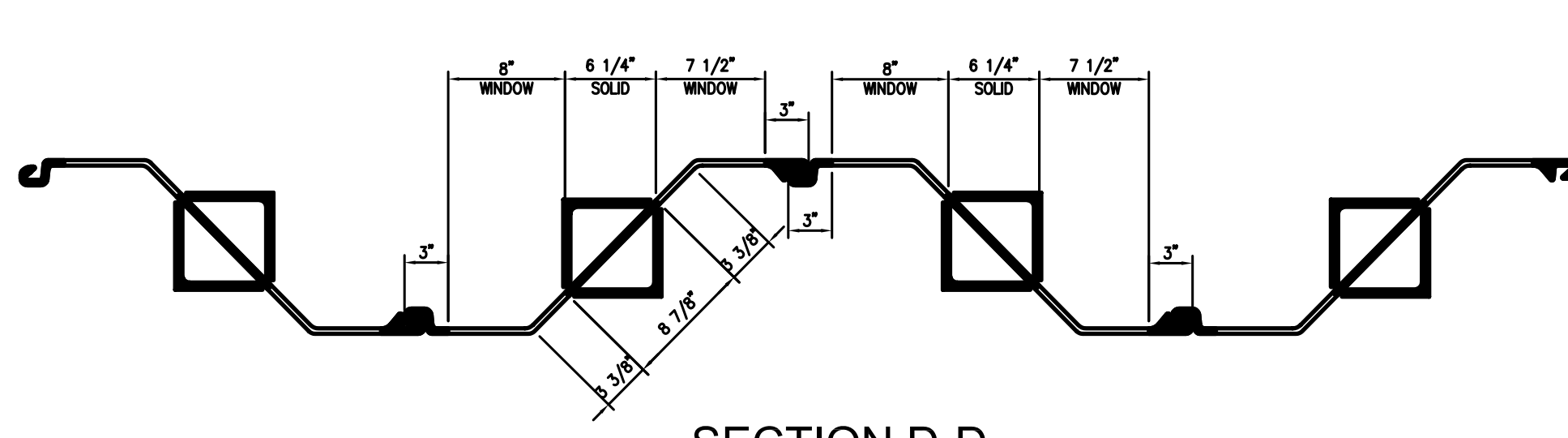

SECTION D-D
SCALE: NTS
PERMANENT SHEET PILING WALL LAYOUT AND EFFECTIVE WINDOW OPENING
SCALE: NTS

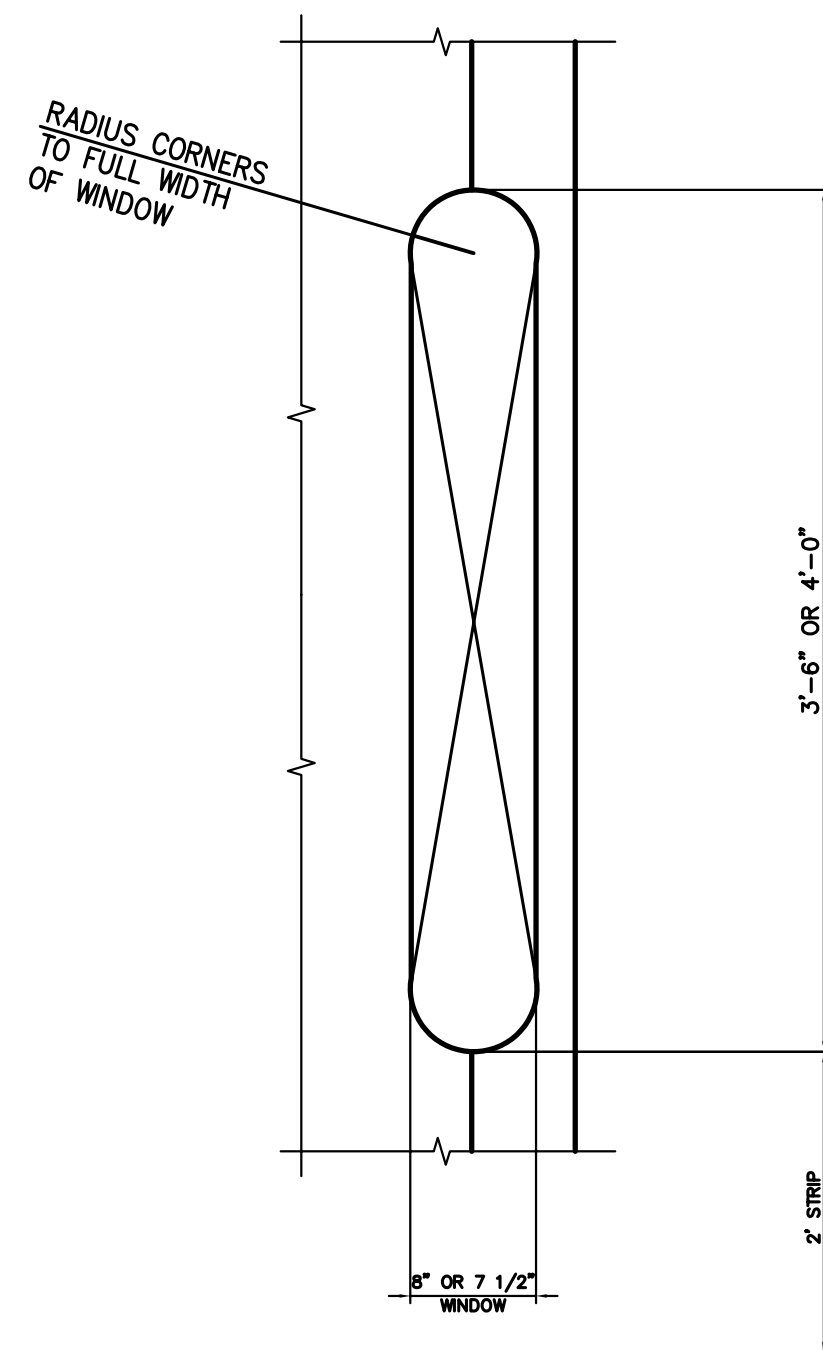

DETAIL C-C
SCALE: NTS

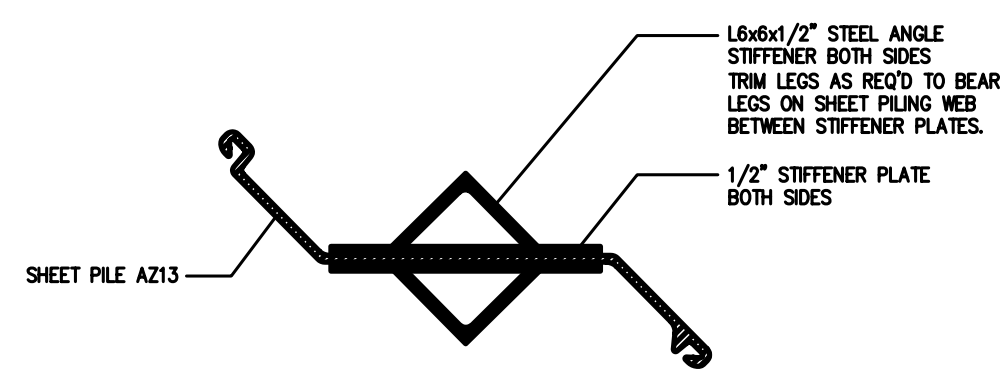

SECTION A-A
SCALE: NTS

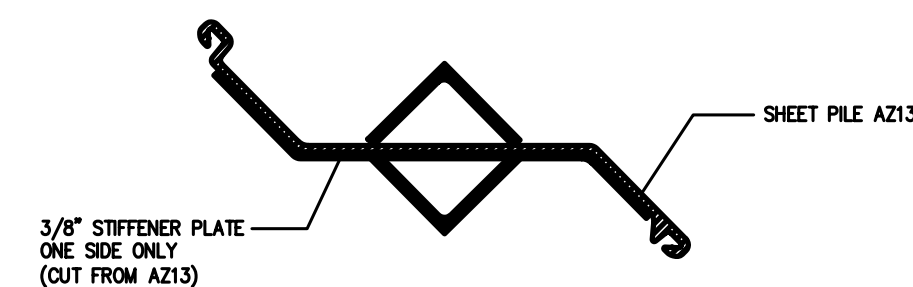

SECTION B-B
SCALE: NTS

SECTION 1 (TYP.) SAND AND STONE DETAIL (SITE-WIDE SOIL CAP AREA)

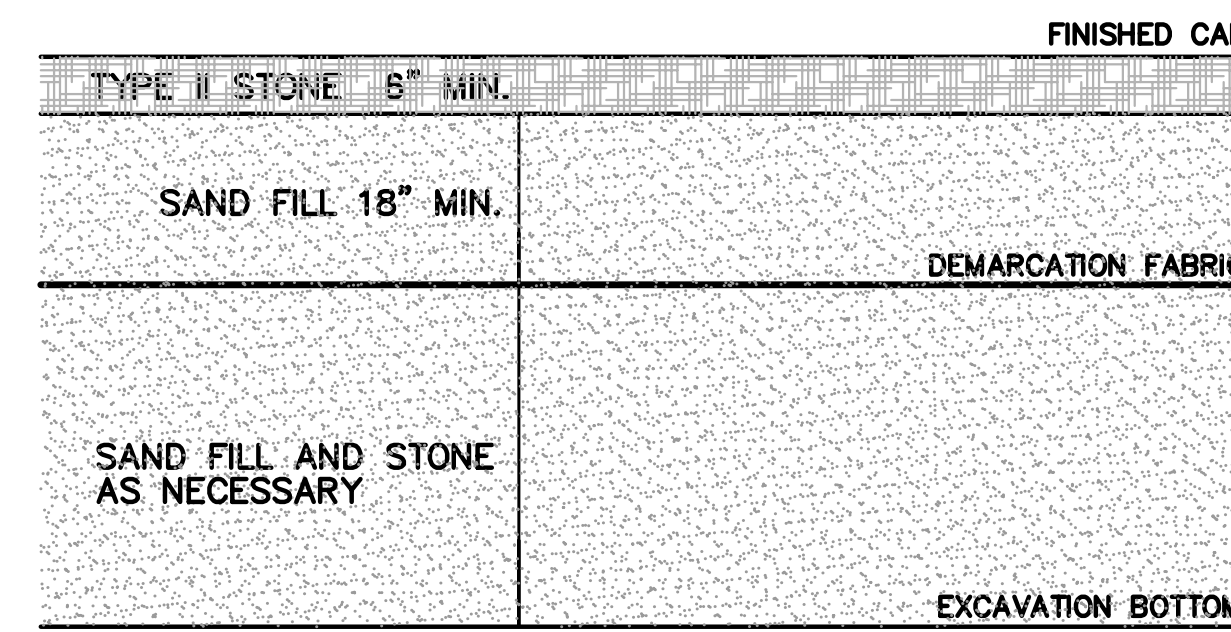

SECTION 2 (TYP.) SAND AND STONE DETAIL (HOT SPOT EXCAVATION AREA)

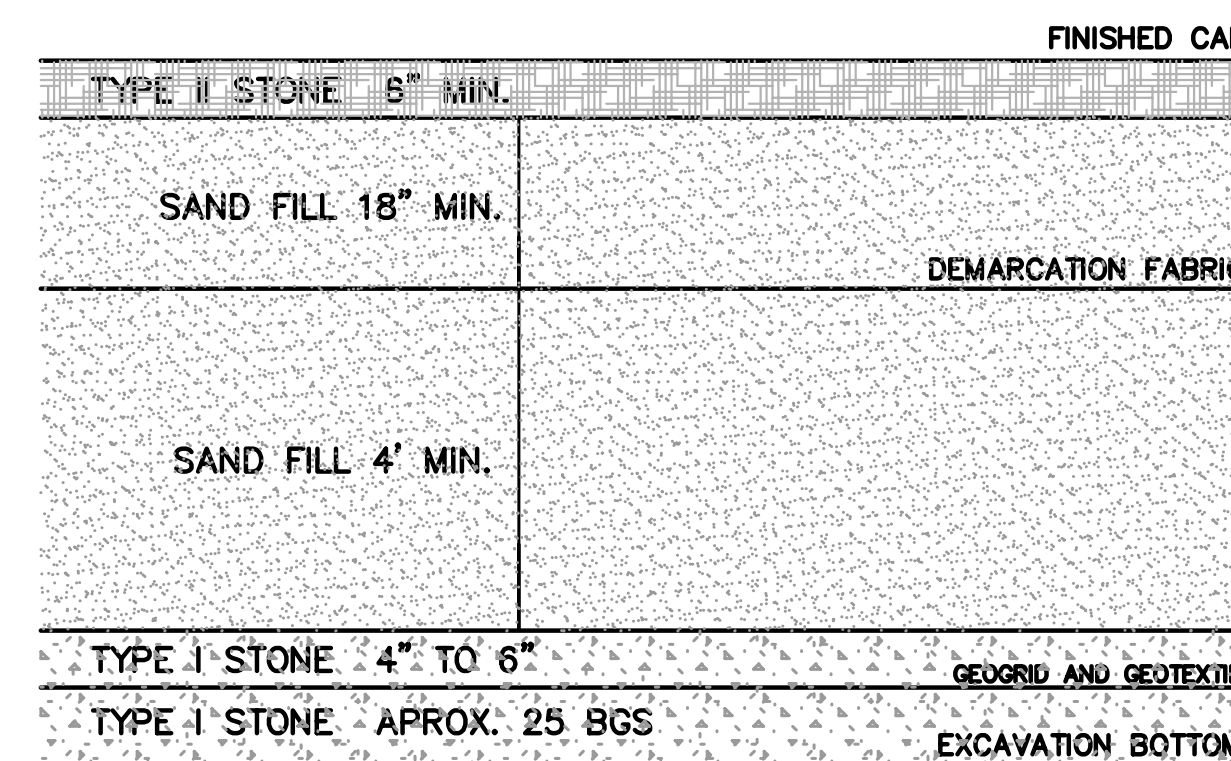

SECTION 3 (TYP.) SAND AND STONE DETAIL (SHALLOW EXCAVATION AREA)

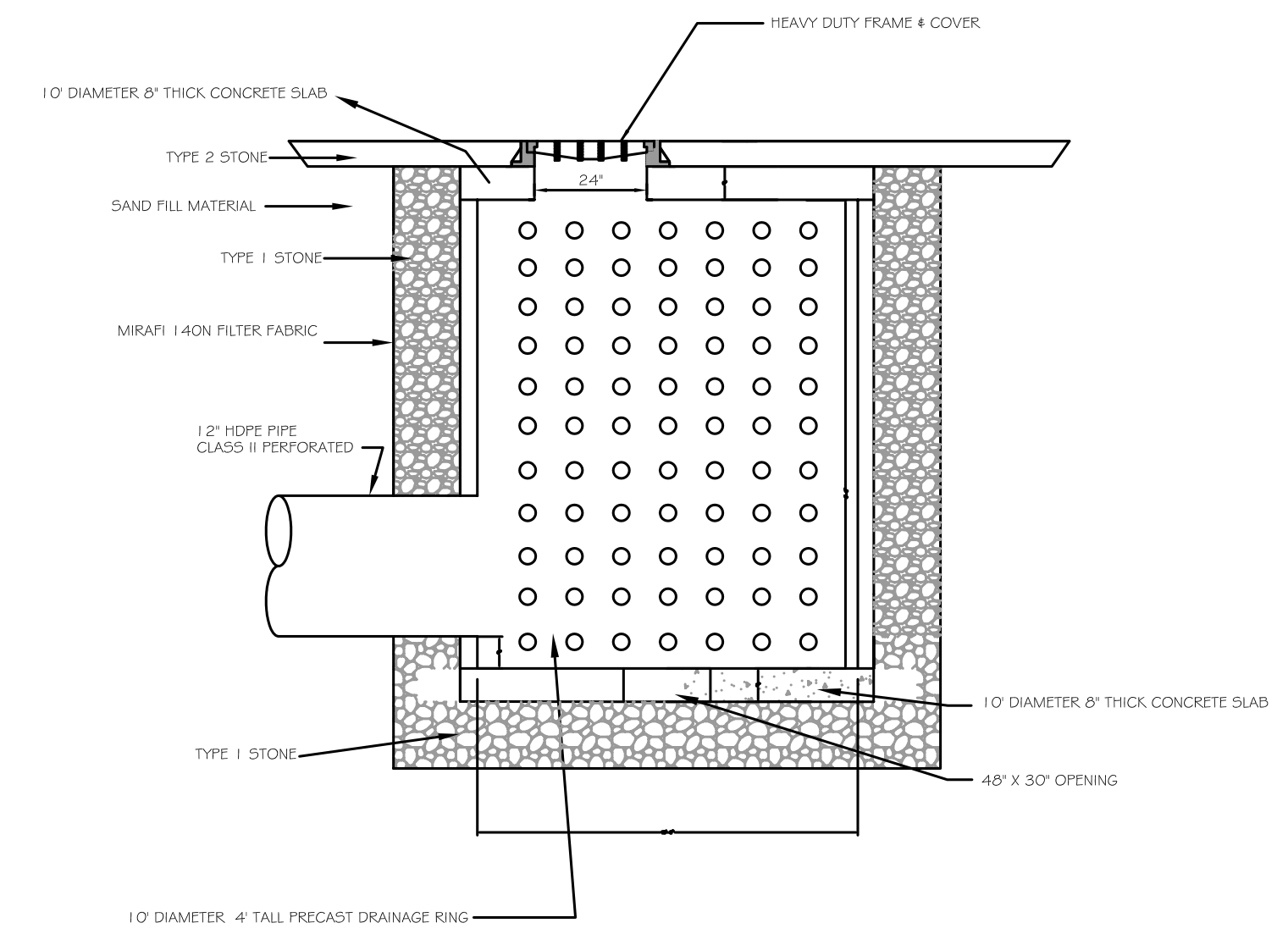
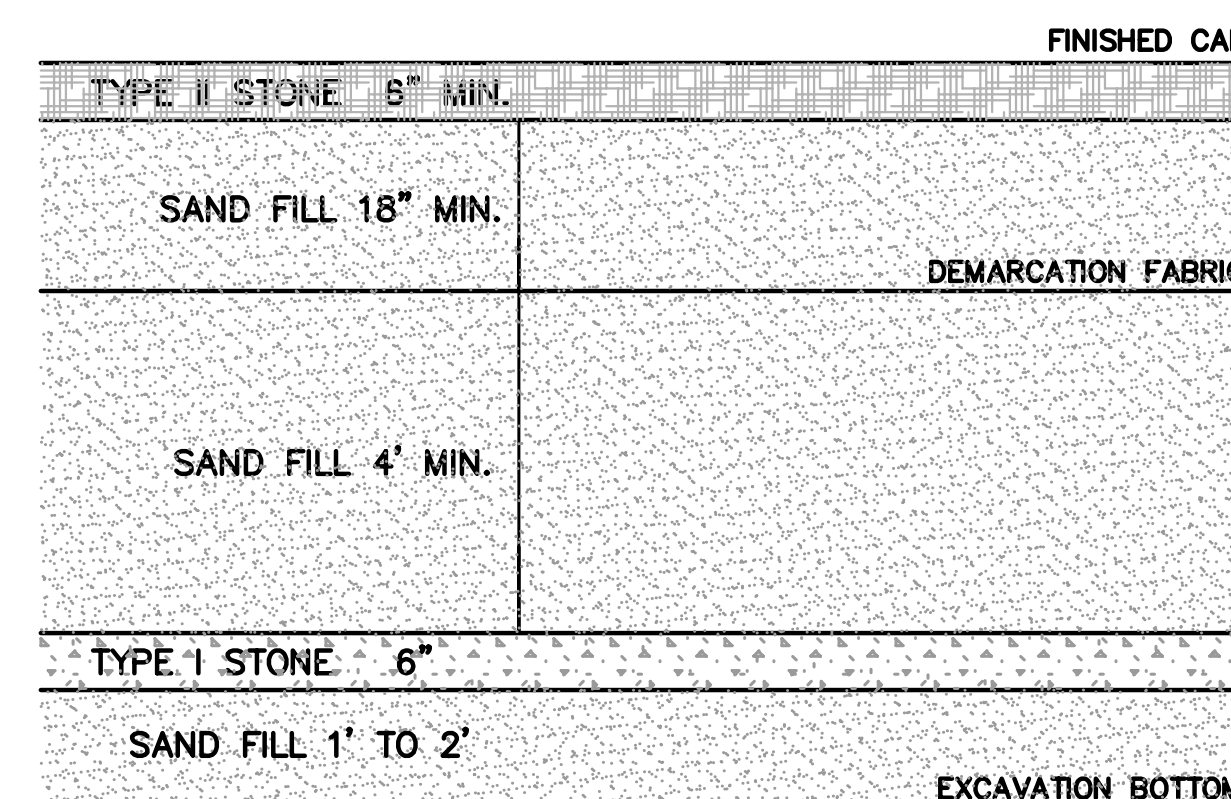

SEEPAGE PIT DETAIL
NOT TO SCALE
SECTION

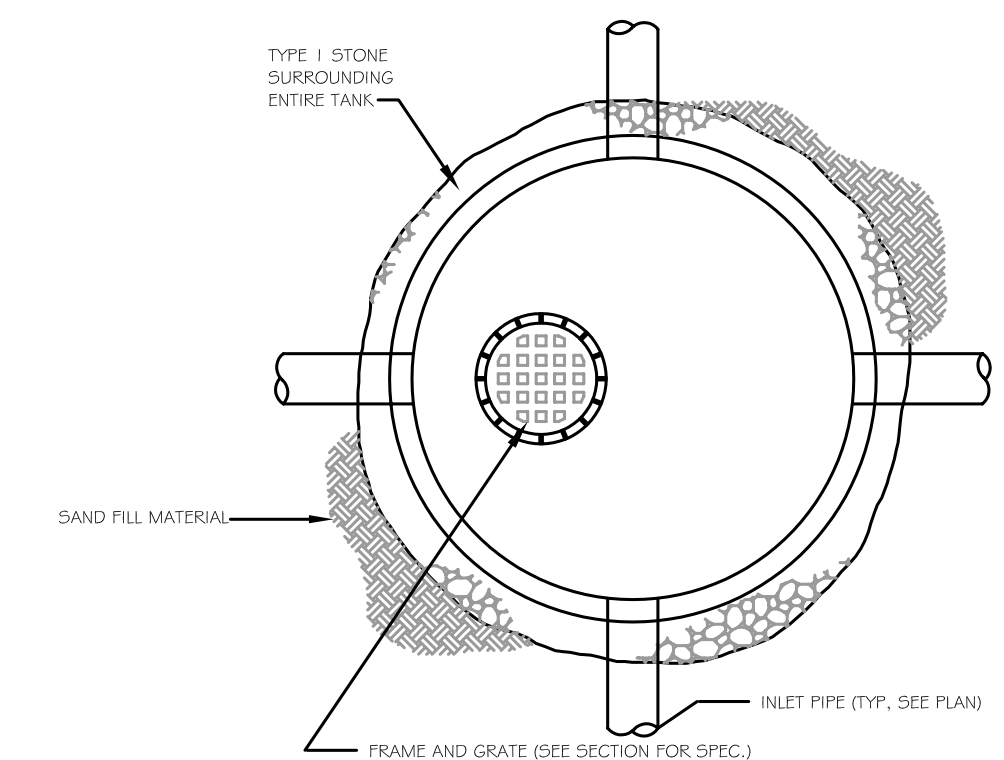

SEEPAGE PIT DETAIL
NOT TO SCALE
PLAN

REV.	DATE	DRAWN BY	DESCRIPTION
3.	3/03/09	RTH	GENERAL REVISIONS
2.	11/20/08	DJM	GENERAL REVISIONS
1.	10/28/08	RTH	GENERAL REVISIONS

<p>LEONARDO E. PONZIO NEW YORK PROFESSIONAL LAND SURVEYOR LIC. NO. 050292-1</p>	<p>MASER CONSULTING P.A. Consulting, Municipal & Environmental Engineers Planners • Surveyors • Landscape Architects State of N.J. Certificate of Authorization: 246A2788500</p>	<p>RED BANK OFFICE 331 Newman Springs Road Suite 203 Red Bank, N.J. 07701 Phone (732) 383-1950 Fax (732) 383-1984 E-mail - solutions@maserconsulting.com</p>	<p>Regional Offices Clinton, N.J. Hamilton, N.J. Logan, N.J. Mt. Arlington, N.J. West Nyack, N.Y. Newburgh, N.Y. Bethlehem, PA.</p>
		<p>AS-BUILT CONSTRUCTION DETAILS FOR ENTACT NATIONAL GRID US BAY SHORE FORMER MANUFACTURED GAS PLANT SITE PHASE II, OU-1 REMEDIAL ACTIONS SITUATE IN: TOWN OF ISLIP SUFFOLK COUNTY NEW YORK</p>	<p>JOB NUMBER: 08000278A SCALE: 1"=20' INDEX NUMBER: 6 of 6</p>